

ZTV55 | ZTV65 | ZTV75

GB | TV Ambient Light



Contents

Safety Instructions and Warnings	2
Package Contents	3
Technical Specifications	4
Device Description	6
Installation and Assembly	7
Controls and Functions	14
Troubleshooting FAQ	20

Safety Instructions and Warnings



Read the user manual before using the device.



Follow the safety instructions stated in the manual.

Before installing or using the product, carefully read in full the instructions provided in the operating manual and make sure you understand them. Keep this document and the packaging for future use.

WARNING

Electrical hazard:

- Improper installation and/or use may cause a fire or injury by electric current.
- Before installing, read the manual and take into account the specific properties of the space and location where the product will be installed.
- Do not open, disassemble, modify or alter the device unless there is a specific instruction to do so in the manual.
- Any unauthorised opening or repair voids all liabilities, rights to replacement or warranties.
- Use only with the original power cable.
- The product can be powered only by voltage that matches the parameters listed for the product.
- Servicing of the product may only be performed by a qualified technician to minimise the risk of injury by electric current.
- Disconnect the product from the power supply before cleaning.
- The product must not be used by persons (including children), whose physical, sensory or mental capabilities or lack of experience and knowledge prevent safe use of the product without supervision or instruction.
- Cleaning and user maintenance must not be performed by unsupervised children.
- Do not submerge the product in water or other liquids.

Fire hazard:

- Do not use the product if any of its parts are damaged or defective. Immediately replace the product if it is damaged or defective.

Suffocation hazard:

- Do not allow children to play with the packaging material. Keep the packaging material out of the reach of children.

WARNING

Trip hazard:

- The power cable and product must always be placed so that they are not in the way of commonly used walking areas.

NOTICES

Risk of damage to the product:

- Use the product only as described in this document.
- Prevent the product from falling and protect it against impacts.
- Do not use aggressive chemical detergents to clean the product.
- Supervise children so that they do not play with the product.





Package Contents

Synchronisation camera
User manual
6× ordinary LED segment
Left and right end LED segment
2× corner joint
4× segment joint
Power adapter



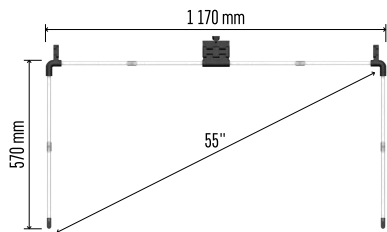

ZTV55

Technical Specifications

Power supply: DC 12 V / 2A

Input power: 24 W

Luminous flux: ZTV55 450 lm / ZTV65 610 lm /
ZTV75 660 lm

Light colour: RGBIC

Cable length: 1.5m

Communication protocol: 2.4 GHz WI-FI
(IEEE802.11b/g/n)

APP: EMOS GoSmart for Android and iOS

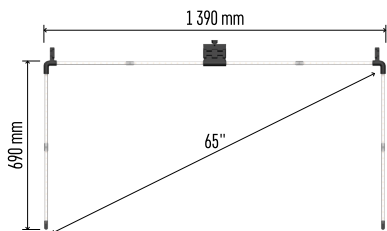

ZTV65

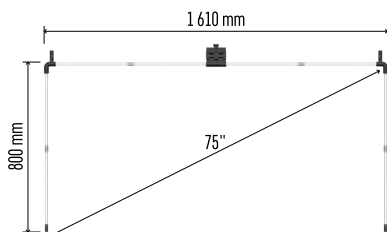

ZTV75

Warning

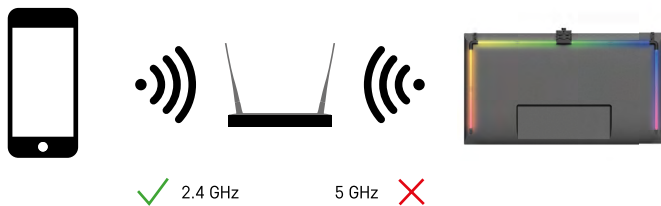

The device only supports 2.4 GHz Wi-Fi (not 5 GHz).



Device Description

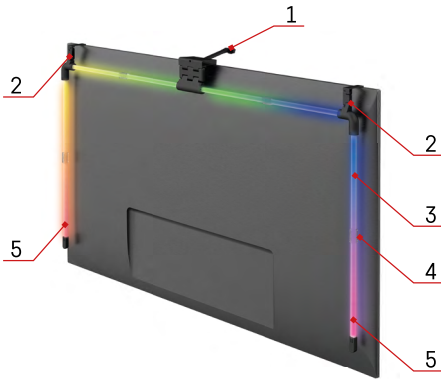

- 1 – Synchronisation camera
- 2 – Corner joints
- 3 – LED segment
- 4 – Segment joint
- 5 – Left and right end LED segment

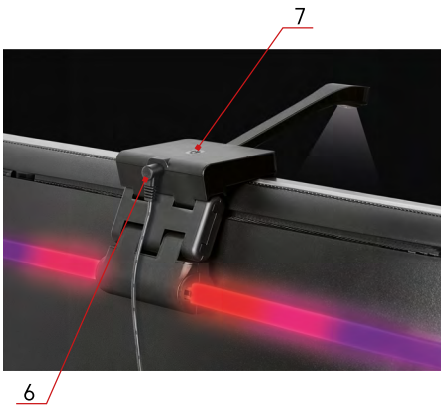

- 6 – Power connector
- 7 – Reset and ON/OFF button



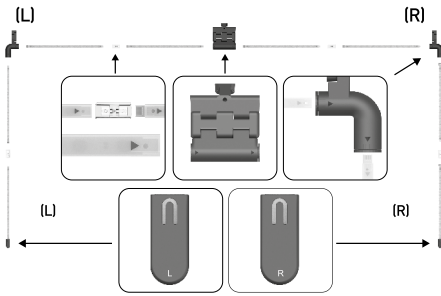

Installation and Assembly

Carefully interconnect all segments. Pay close attention to the correct orientation of the segments to avoid damaging the connectors.

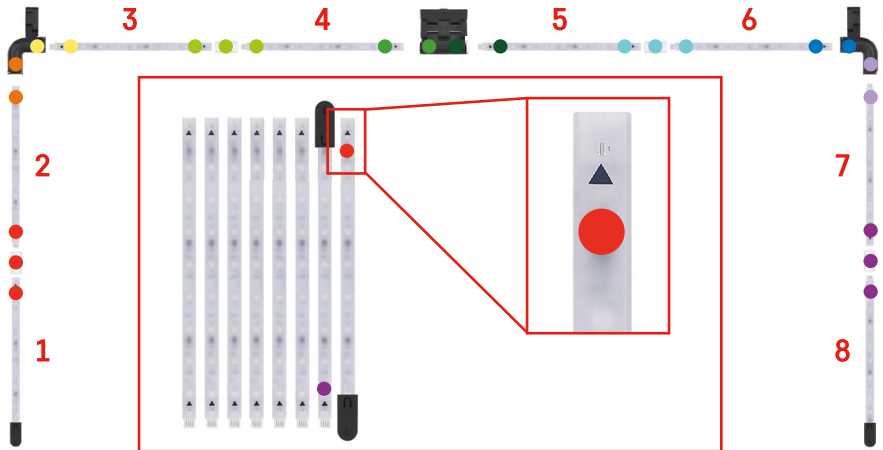

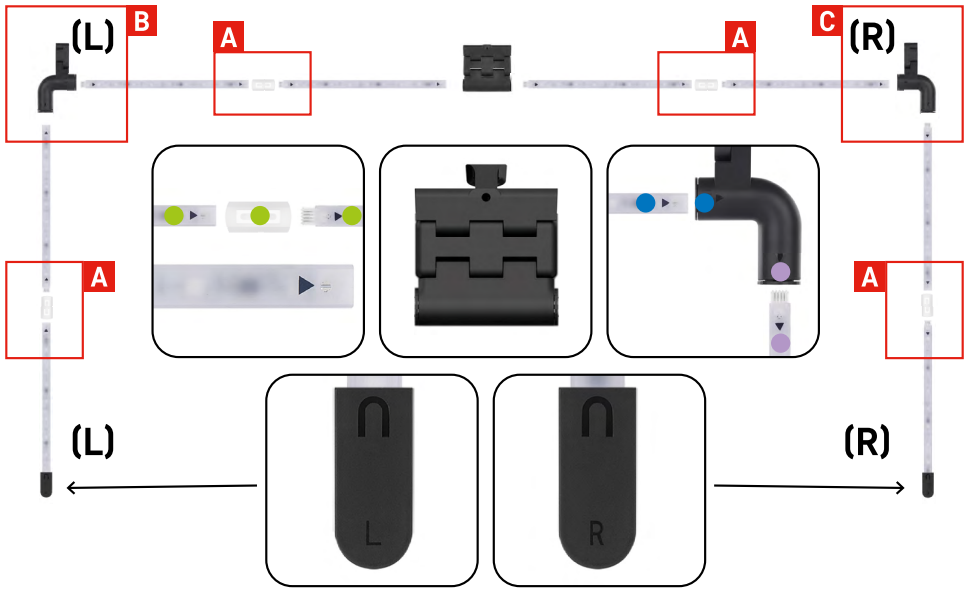

A

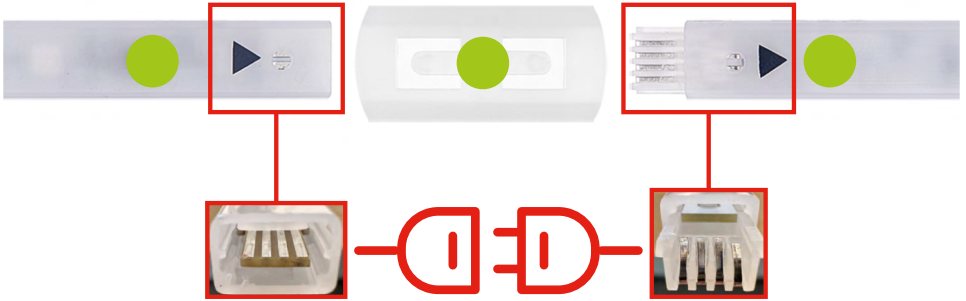

B

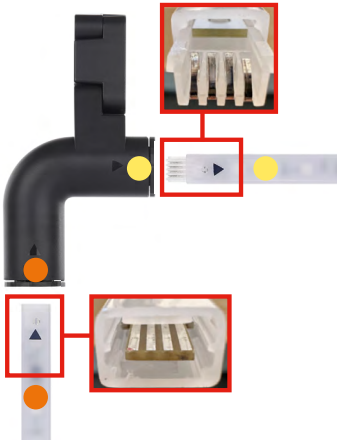

C

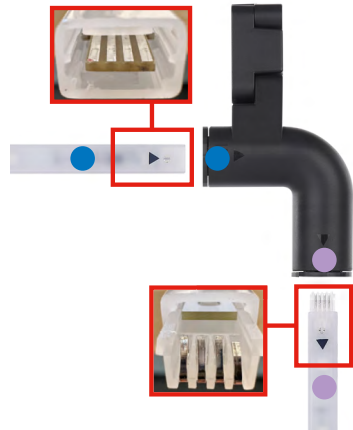

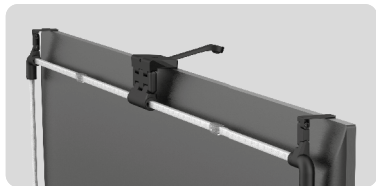

Hang the entire structure by the 2 corner brackets and the camera on the back of the TV and remove the protective film from the camera lens.

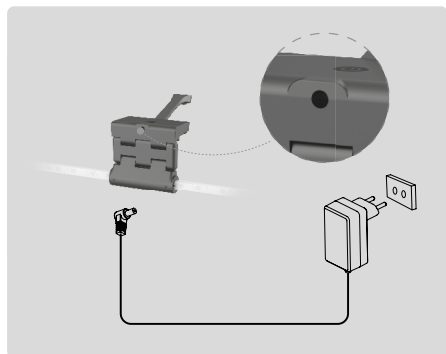

Plug in the power adapter.

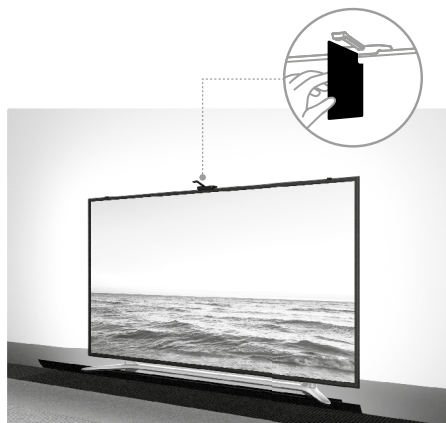

For best results, it is important to tilt the synchronisation camera correctly. To do this, use the supplied angle card and align the back of it with the TV screen so that the top edge touches the camera. Then tilt the camera to align it with the angle card.

Pairing with the App

Installing the EMOS GoSmart App



The app is available for Android and iOS on Google Play and App Store. Download the app by scanning the QR code.

Steps in the EMOS GoSmart Mobile App

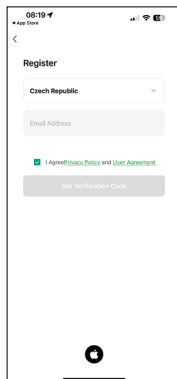
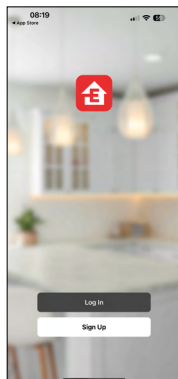
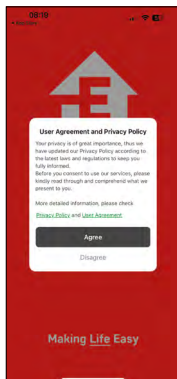

Open EMOS GoSmart and confirm the privacy policy by tapping Agree.
Choose Sign Up.
Enter a valid e-mail address and choose a password.
Confirm that you agree to the privacy policy.
Choose Sign Up.

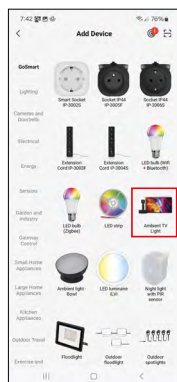
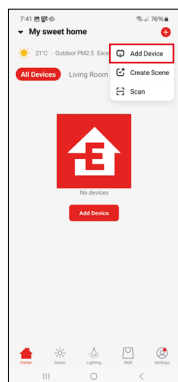
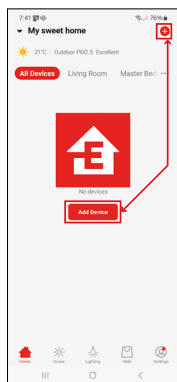

Choose Add Device.
Choose the GoSmart product category and choose device Ambient TV Light.

Bluetooth



Follow the instructions in the app and make sure Bluetooth is turned on on your phone.

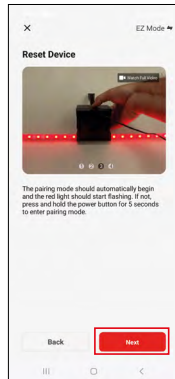
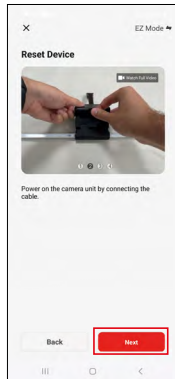
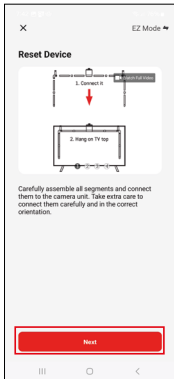



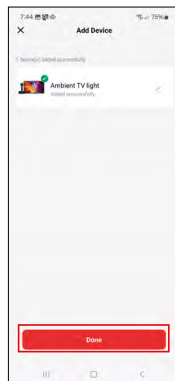
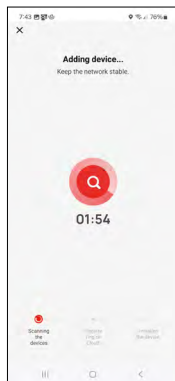
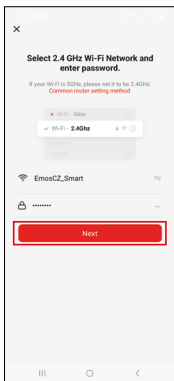



Reset the device by holding the button on the camera for 5 seconds.

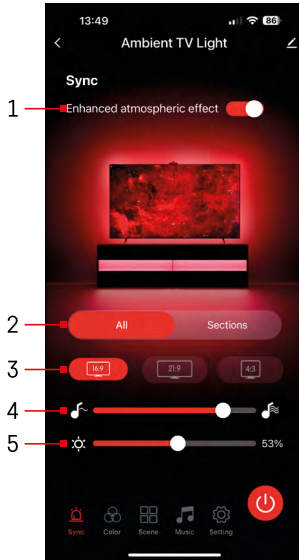

Enter the name and password to your Wi-Fi network. The information remains encrypted and is used only so that the keypad is able to communicate with your mobile device remotely. The device will be detected automatically. After pairing, the keypad can be renamed.

Icons and Indicators



1	Enhanced atmospheric effect
2	Select settings for the entire light or for individual segments
3	Set the video format on your TV
4	Colour transition speed
5	Brightness settings
	Set synchronisation of the light with the TV screen
	Set the colour mode
	Select from preset scenes
	Synchronisation with music and sound
	Settings
	On/off button



Controls and Functions

Setting the Colour Mode

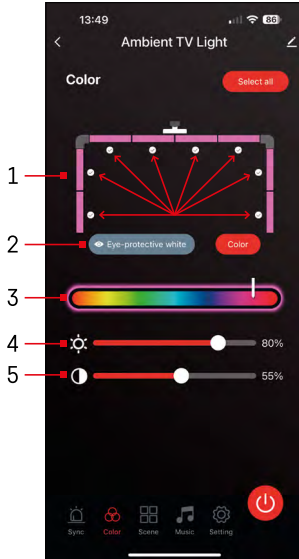

- 1 – The control panel consists of 8 segments that can be manually controlled. By default, all segments are selected, which means that any colour change will affect all segments. If you want to change the colour of only a few (for example, half of them), it is possible to select/deselect some segments and change the colour of only those segments for which the box is checked.
- 2 – "Eye-protective white" and "Colour" are options that change the behaviour of this setting. If you select the "Eye-protective white" option, all segments will change to white, which serves only as an ambient light that is gentle on the eyes and minimizes eye fatigue when watching TV, especially in low light. On the other hand, selecting the "Colour" option allows you to customize the segments with different colours, providing more vibrant and dynamic lighting according to your preference or mood.
- 3 – Choice of colour
- 4 – Brightness settings
- 5 – Contrast settings

Selection and Creation of Scenes

The app contains several predefined scenes from which you can choose. If none of them suit your needs, there is a large "+" sign at the bottom of the list that allows you to create your own scene.

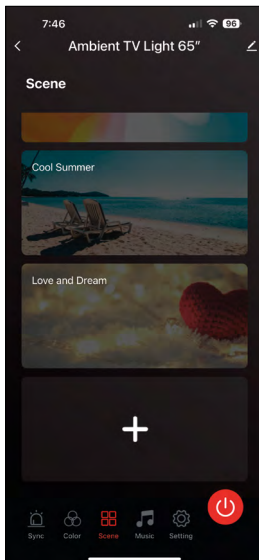

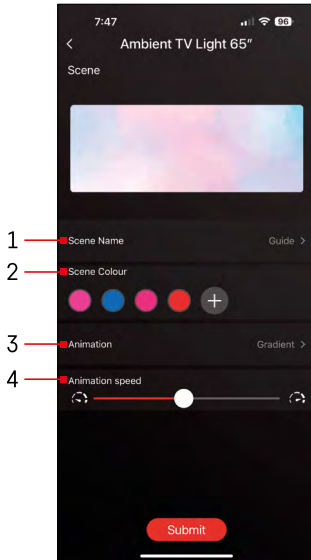

- 1 – Scene name
- 2, 3, 4 – Scene colour, animation and animation speed. We recommend selecting an animation style first, as this option will affect the number of colours you can choose. Some animations allow only 1 colour and some allow more. If you see a plus sign next to the colours, it means you can add more colours as needed. As an example, we chose the "gradient" animation style, which will smoothly transition between the selected colours – pink, blue, pink and red. You can change the speed of this animation using the slider at the bottom of this page.

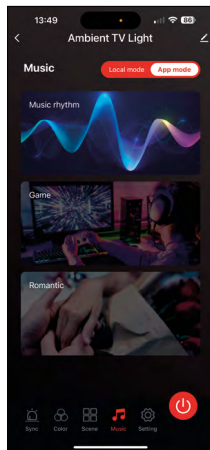
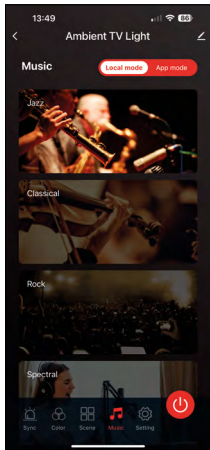

Synchronisation with Music and Sound



The app offers 2 music synchronisation modes: "Local mode" and "App mode". Both modes offer several options that adjust sound detection sensitivity and light response.

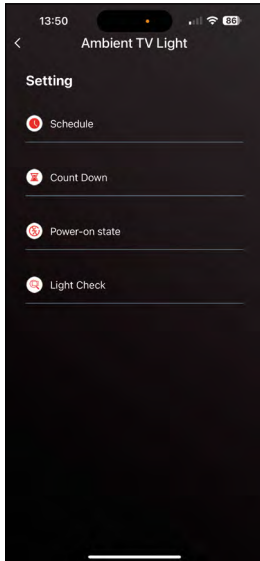

Settings section

Schedule

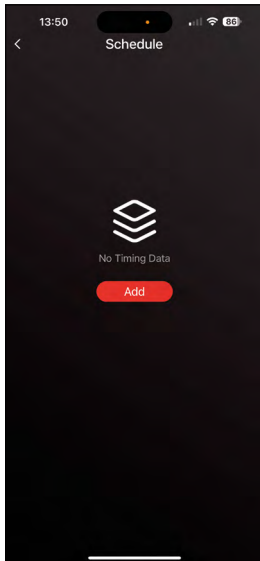

Scheduling allows you to set the times when the ambient TV light automatically turns on or off. This option not only allows you to schedule the lights to turn on or off, but also to select the mode in which the lights should turn on, whether they should start synchronising immediately or stay in just one colour, or play a scene.

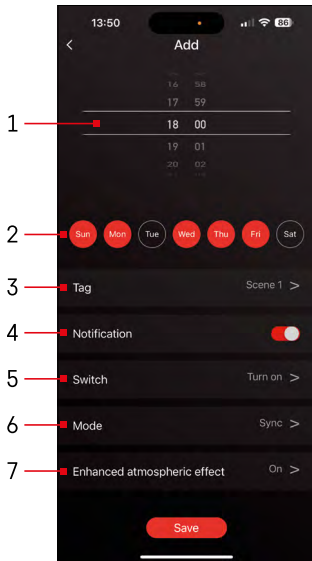

- 1, 2 – Selection of the time and days when the light is to turn on or off
- 3 – Schedule name
- 4 – The notification function will inform you when a schedule starts
- 5 – A setting whether the light should switch on or off at schedule start
- 6 – Mode settings (synchronisation, colour, scene or music)
- 7 – Switch the atmospheric effect on/off

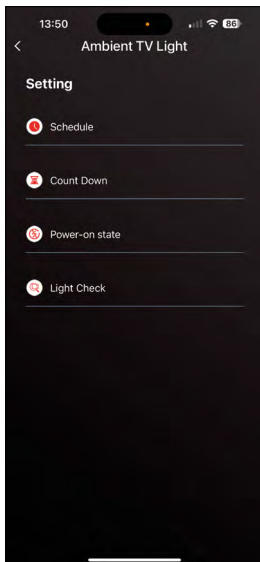

Countdown / Delayed shutdown

The light will automatically switch off after the set time has elapsed.

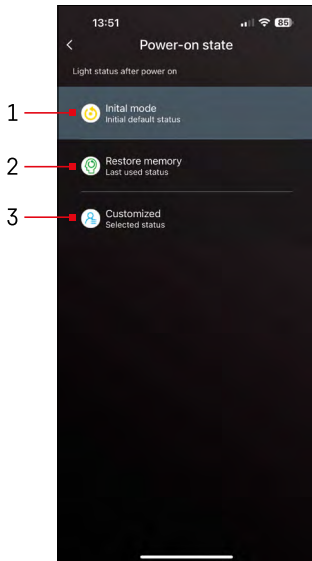

Status after switching on

If the device loses power (adapter disconnection or power cut), this setting determines what happens when power is restored.

- 1 – Restore to default setting
- 2 – Restore to last used setting
- 3 – Custom setting, for example, so that the device always lights up red when power is restored.

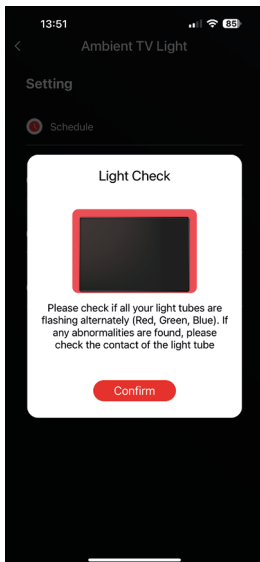

LED Segment Check

If you notice that some lights are behaving unusually (flashing, unresponsive...), we recommend using this function to check where the problem might be.

When this function is selected, all segments should change to the same colour with a gradual colour change. If some segments change more slowly, this may indicate faulty connections, which we recommend cleaning.

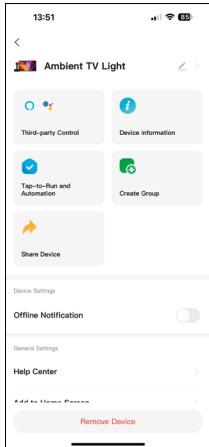

Explanation of Advanced Settings

- **Device Information** – basic information about the device
- **Tap-To-Run and Automation** – scenes and automations assigned to the device
- **Offline Notification** – notifies when the device is offline for over 8 hours (e.g. power outage)
- **Create Group** – creates a group of similar devices (most suitable for lights, e.g. for putting all lights in the kitchen in the same group)
- **Faq and Feedback** – frequently asked questions and feedback
- **Add to Home Screen** – adds an icon for the device on the phone's home screen
- **Check Device Network** – checks the functionality of the Wifi network
- **Device Update** – updates the device
- **Remove Device** – cancels device pairing



Troubleshooting FAQ

The devices are not pairing. What should I do?

- Make sure you are using a 2.4 GHz Wi-Fi network and have a sufficiently strong signal.
- Give the app all permissions in the settings.
- Check that you are using an up-to-date version of the mobile operating system and the latest version of the app.

Who is allowed to use the device?

- The device must always have an admin (owner).
- The admin can then share the device with other people in the household and assign them rights.



GB | Hereby, EMOS spol. s r.o., declares that the radio equipment type ZTV55, ZTV65, ZTV75 is in compliance with Directive 2014/53/EU. The full text of the EU declaration of conformity is available at the following internet address: <http://www.emos.eu/download>.

CZ | Tímto EMOS spol. s r.o. prohlašuje, že typ rádiového zařízení ZTV55, ZTV65, ZTV75 je v souladu se směrnicí 2014/53/EU. Úplné znění EU prohlášení o shodě je k dispozici na těchto internetových stránkách <http://www.emos.eu/download>.

Zařízení lze provozovat na základě všeobecného oprávnění č. VO-R/10/05.2025-5 v platném znění.

SK | EMOS spol. s r.o. týmto vyhlasuje, že rádiové zariadenie typu ZTV55, ZTV65, ZTV75 je v súlade so smernicou 2014/53/EÚ. Úplné EÚ vyhlásenie o zhode je k dispozícii na tejto internetovej adrese: <http://www.emos.eu/download>.

PL | EMOS spol. s r.o. niniejszym oświadcza, że typ urządzenia radiowego ZTV55, ZTV65, ZTV75 jest zgodny z dyrektywą 2014/53/UE. Pełny tekst deklaracji zgodności UE jest dostępny pod następującym adresem internetowym: <http://www.emos.eu/download>

 Zgodnie z przepisami Ustawy o ZSEiE zabronione jest umieszczanie łącznie z innymi odpadami zużytego sprzętu oznakowanego symbolem przekreślonego kosza. Użytkownik, chcąc pozbyć się sprzętu — elektronicznego i elektrycznego, jest zobowiązany do oddania go do punktu zbierania zużytego sprzętu. W sprzęcie nie znajdują się składniki niebezpieczne, które mają szczególnie negatywny wpływ na środowisko i zdrowie ludzi. Obecność w sprzęcie niebezpiecznych substancji, mieszanin oraz części składowych ma potencjalny (szkodliwy) wpływ dla środowisko i zdrowie ludzi.

HU | EMOS spol. s r.o. igazolja, hogy a ZTV55, ZTV65, ZTV75 típusú rádióberendezés megfelel a 2014/53/EU irányelvnek. Az EU-megfelelőségi nyilatkozat teljes szövege elérhető a következő internetes címen: <http://www.emos.eu/download>.

SI | EMOS spol. s r.o. potrjuje, da je tip radijske opreme ZTV55, ZTV65, ZTV75 skladen z Direktivo 2014/53/EU. Celotno besedilo izjave EU o skladnosti je na voljo na naslednjem spletnem naslovu: <http://www.emos.eu/download>

RS|HR|BA|ME | EMOS spol. s r.o. ovime izjavljuje da je radijska oprema tipa ZTV55, ZTV65, ZTV75 u skladu s Direktivom 2014/53/EU Cjeloviti tekst EU izjave o skladnosti dostupan je na sljedećoj internetskoj adresi: <http://www.emos.eu/download>.

DE | Hiermit erklärt EMOS spol. s r.o., dass der Funkanlagentyp ZTV55, ZTV65, ZTV75 der Richtlinie 2014/53/EU entspricht. Der vollständige Text der EU-Konformitätserklärung ist unter der folgenden Internetadresse verfügbar: <http://www.emos.eu/download>.

UA | Цим підприємство EMOS spol. s r.o. проголошує, що тип радіообладнання ZTV55, ZTV65, ZTV75 відповідає Директивам 2014/53/EU. Повний текст ЄС проголошення про відповідність можна знайти на цьому сайті <http://www.emos.eu/download>.

RO|MD | Prin prezenta, EMOS spol. s r.o. declară că tipul de echipamente radio ZTV55, ZTV65, ZTV75 este în conformitate cu Directiva 2014/53/UE. Textul integral al declarației UE de conformitate este disponibil la următoarea adresă internet: <http://www.emos.eu/download>.

LT | Aš, EMOS spol. s r.o. patvirtinu, kad radijo įrenginių tipas ZTV55, ZTV65, ZTV75 atitinka Direktyvą 2014/53/ES. Visas ES atitikties deklaracijos tekstas prieinamas šiuo interneto adresu: <http://www.emos.eu/download>.

LV | Ar šo EMOS spol. s r.o. deklarē, ka radioiekārta ZTV55, ZTV65, ZTV75 atbilst Direktīvai 2014/53/ES. Pilns ES atbilstības deklarācijas teksts ir pieejams šādā interneta vietnē: <http://www.emos.eu/download>.

EE | Käesolevaga deklareerib EMOS spol. s r.o. et käesolev raadioseadme tüüp ZTV55, ZTV65, ZTV75 vastab direktiivi 2014/53/EL nõuetele. Eli vastavusdeklaratsiooni täielik tekst on kättesaadav järgmisel internetiaadressil: <http://www.emos.eu/download>.

BG | С настоящото EMOS spol. s r.o. декларира, че този тип радиосъоръжение ZTV55, ZTV65, ZTV75 е в съответствие с Директива 2014/53/ЕС. Цялостният текст на ЕС декларацията за съответствие може да се намери на следния интернет адрес: <http://www.emos.eu/download>.

FR|BE | Le soussigné, EMOS spol. s r.o., déclare que l'équipement radioélectrique du type ZTV55, ZTV65, ZTV75 est conforme à la directive 2014/53/UE. Le texte complet de la déclaration UE de conformité est disponible à l'adresse internet suivante: <http://www.emos.eu/download>.

IT | Il fabbricante, EMOS spol. s r.o. dichiara che il tipo di apparecchiatura radio ZTV55, ZTV65, ZTV75 è conforme alla direttiva 2014/53/UE. Il testo completo della dichiarazione di conformità UE è disponibile al seguente indirizzo Internet: <http://www.emos.eu/download>.

NL | Hierbij verklaar ik, EMOS spol. s r.o., dat het type radioapparatuur ZTV55, ZTV65, ZTV75 conform is met Richtlijn 2014/53/EU. De volledige tekst van de EU-conformiteitsverklaring kan worden geraadpleegd op het volgende internetadres: <http://www.emos.eu/download>.

ES | Por la presente, EMOS spol. s r.o. declara que el tipo de equipo radioeléctrico ZTV55, ZTV65, ZTV75 es conforme con la Directiva 2014/53/UE. El texto completo de la declaración UE de conformidad está disponible en la dirección Internet siguiente: <http://www.emos.eu/download>.

PT | O(a) abaixo assinado(a) EMOS spol. s r.o. declara que o presente tipo de equipamento de rádio ZTV55, ZTV65, ZTV75 está em conformidade com a Diretiva 2014/53/UE. O texto integral da declaração de conformidade está disponível no seguinte endereço de Internet: <http://www.emos.eu/download>.

GR|CY | Με την παρούσα ο/η EMOS spol. s r.o. δηλώνει ότι ο ραδιοεξοπλισμός ZTV55, ZTV65, ZTV75 πληροί την οδηγία 2014/53/ΕΕ. Το πλήρες κείμενο της δήλωσης συμμόρφωσης ΕΕ διατίθεται στην ακόλουθη ιστοσελίδα στο διαδίκτυο: <http://www.emos.eu/download>.

SE | Härmed försäkrar EMOS spol. s r.o. att denna typ av radioutrustning ZTV55, ZTV65, ZTV75 överensstämmer med direktiv 2014/53/EU. Den fullständiga texten till EU-försäkran om överensstämmelse finns på följande webbadress: <http://www.emos.eu/download>.

FI | EMOS spol. s r.o. vakuuttaa, että radiolaitetyypit ZTV55, ZTV65, ZTV75 on direktiivin 2014/53/EU mukainen. EU-vaatimustenmukaisuusvakuutuksen täysimittainen teksti on saatavilla seuraavassa internetosoitteessa: <http://www.emos.eu/download>.

DK | Hermed erklærer EMOS spol. s r.o., at radioudstyrstypen ZTV55, ZTV65, ZTV75 er i overensstemmelse med direktiv 2014/53/EU. EU-overensstemmelseserklæringens fulde tekst kan findes på følgende internetadresse: <http://www.emos.eu/download>.